

PLAN
(1:1000)

LEVEL DATUM =20.00	
PROPOSED LEVELS	EXISTING LEVELS
1640.000	10.153
1650.000	10.236
1660.000	10.319
1670.000	10.402
1680.000	10.485
1690.000	10.568
1700.000	10.651
1710.000	10.734
1720.000	10.817
1730.000	10.900
1740.000	10.983
1750.000	11.066
1760.000	11.149
1770.000	11.232
1780.000	11.314
1790.000	11.397
1800.000	11.480
1810.000	11.563
1820.000	11.646
1824.838	11.686
1830.000	11.729
1840.000	11.812
1850.000	11.895
1860.000	11.978
1870.000	12.061
1880.000	12.144
1890.000	12.227
1896.843	12.284
1900.000	12.310
1910.000	12.393
1920.000	12.476
1930.000	12.559
1940.000	12.642
1950.000	12.725
1958.564	12.796
1960.000	12.808
1970.000	12.891
1980.000	12.974
1990.000	13.056
2000.000	13.139
2010.000	13.222
2020.000	13.305
2025.427	13.350
2030.000	13.387
2040.000	13.454
2044.564	13.479
2045.199	13.485
2050.000	13.508
2060.000	13.556
2070.000	13.606
2080.000	13.656
2090.000	13.706
2100.000	13.756
2110.000	13.806
2120.000	13.856
2130.000	13.906
2140.000	13.956
2150.000	14.006
2160.000	14.056
2170.000	14.106
2180.000	14.156
2190.000	14.206
2200.000	14.256
2210.000	14.306
2219.444	14.353

LONGITUDINAL SECTION
(CHAINAGES: 1800m - 2115m)
(H: 1:1000 V: 1:200)

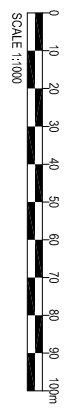
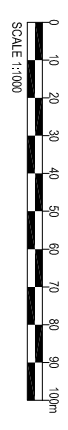

PROJECT
 WYLFA
 A5025 HIGHWAY IMPROVEMENTS
CLIENT



HORIZON NUCLEAR POWER
 Sunrise House, 1420 Charlton Court,
 Gloucester Business Park, Gloucester,
 GL3 4AE // Tel: 0845 300 6816
 www.horizonnuclearpower.com

CONSULTANT
 AECOM Manchester
 Bridgewater House, Whitworth Street,
 Manchester, M1 6LT
 0161 907 3500 tel 0161 907 3599 fax
 www.aecom.com

KEY

- PLANNING APPLICATION RED LINE BOUNDARY
- PROPOSED CARRIAGEWAY
- PROPOSED SHARED USE FOOTWAY/CYCLEWAY
- PROPOSED VERGE
- PROPOSED EARTHWORKS SLOPES
- PROPOSED FARM ACCESS TRACK
- EXISTING WATERCOURSE
- PROPOSED ATTENUATION POND
- PROPOSED HIGHWAY BOUNDARY FENCE
- PROPOSED GATED PUA
- PROPOSED LAND DRAINAGE DITCH
- PROPOSED VEHICLE SAFETY BARRIER

NOTES

1. DRAWN AT SCALE 1:1000 @ A1.
2. ALL EARTHWORKS BATTER SLOPES ARE SHOWN AT A GRADIENT OF 1 IN 2.5.
3. EXISTING GROUND LEVELS BASED ON TOPOGRAFICAL SURVEY INFORMATION FROM BNSK SURVEYS UNDER PASSED DESIGNATION VV1011517.2m WIDE WITH 1.0m MARGINS ON BOTH SIDES OF THE ROAD ALIGNMENT GEOMETRY HAS BEEN DESIGNED IN ACCORDANCE WITH DMRB TD 1607.
4. ROUNDABOUT GEOMETRY HAS BEEN DESIGNED IN ACCORDANCE WITH DMRB TD 1607.
5. ROUNDABOUT GEOMETRY HAS BEEN DESIGNED IN ACCORDANCE WITH DMRB TD 1607.
6. ROUNDABOUT GEOMETRY HAS BEEN DESIGNED IN ACCORDANCE WITH DMRB TD 1607.
7. FOR DETAILS OF PROPOSED DRAINAGE REFER TO DRAWINGS WV02.05-ACM-S5-DRG-001 & 002.

ISSUE/REVISION

IR	DATE	DESCRIPTION
P1	18.11.16	ISSUED FOR INFORMATION

PROJECT NUMBER
47071078

SHEET TITLE
SECTION 3

PROPOSED GENERAL ARRANGEMENT
SHEET 4 OF 4

SHEET NUMBER

WV02.05-ACM-S3-00-DRG-104 P1

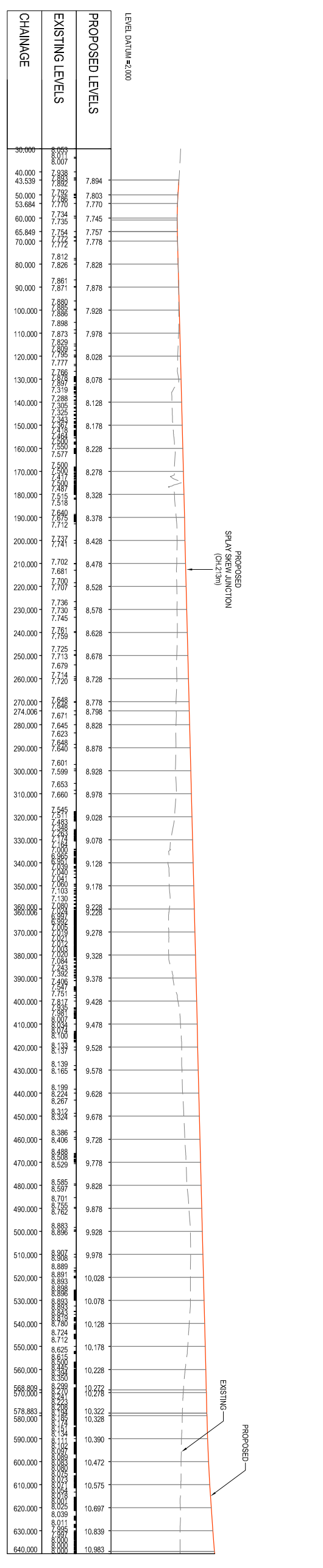
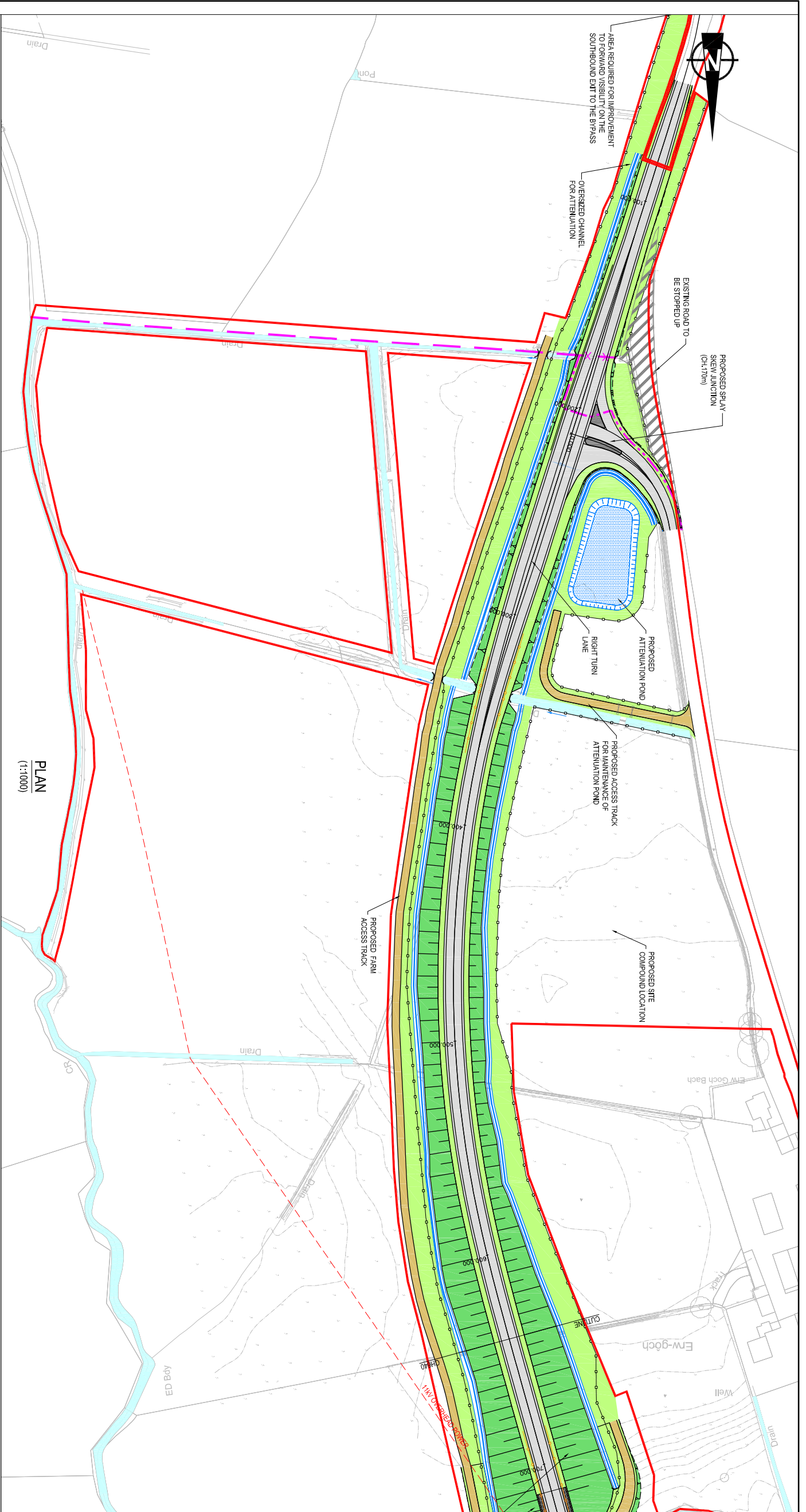

LONGITUDINAL SECTION
 (CHAINAGES: 0m - 600m)
 (H: 1:1000 V: 1:200)

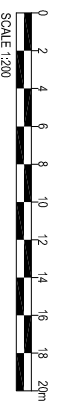
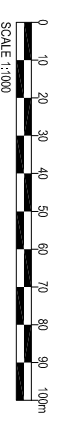

PROJECT
 WYLFA
 A5025 HIGHWAY IMPROVEMENTS
CLIENT



HORIZON NUCLEAR POWER
 Sunrise House, 1420 Charlton Court,
 Gloucester Business Park, Gloucester,
 GL3 4AE // Tel: 0845 300 6816
 www.horizonnuclearpower.com

CONSULTANT
 AECOM Manchester
 Bridgewater House, Whitworth Street,
 Manchester, M1 6LT
 0161 907 3500 tel 0161 907 3599 fax
 www.aecom.com

KEY

- PLANNING APPLICATION RED LINE BOUNDARY
- PROPOSED CARRIAGEWAY
- PROPOSED SHARED USE FOOTWAY/CYCLEWAY
- PROPOSED VERGE
- PROPOSED EARTHWORKS SLOPES
- PROPOSED FARM ACCESS TRACK
- EXISTING WATERCOURSE
- PROPOSED ATTENUATION POND
- PROPOSED HIGHWAY BOUNDARY FENCE
- PROPOSED GATED PUA
- PROPOSED GATED PUA
- PROPOSED LAND DRAINAGE DITCH
- PROPOSED VEHICLE SAFETY BARRIER

NOTES

1. DRAWN AT SCALE 1:1000 @ A1.
2. ALL EARTHWORKS BATTER SLOPES ARE SHOWN AT A GRADIENT OF 1 IN 2.5.
3. EXISTING GROUND LEVELS BASED ON TOPOGRAFICAL SURVEY INFORMATION FROM RISK SURVEYS UNDERTAKEN ON THE SITE IN 2015.
4. THE PROPOSED CARRIAGEWAY WIDTH IS 7.2m WIDE WITH 1.0m MARGINS ON BOTH SIDES OF THE ROAD ALIGNMENT PROVIDING A 9.3m TOTAL PAVED WIDTH.
5. ROUNDABOUT GEOMETRY HAS BEEN DESIGNED IN ACCORDANCE WITH DMRB TD 993.
6. ROUNDABOUT GEOMETRY DESIGNED IN ACCORDANCE WITH DMRB TD 1607.
7. FOR DETAILS OF PROPOSED DRAINAGE REFER TO DRAWINGS WN02-05-ACM-S5-05-DRG-001 & 002.

ISSUE/REVISION

IR	DATE	DESCRIPTION
P1	18.11.16	ISSUED FOR COMMENT

PROJECT NUMBER
 47071078

SHEET TITLE

SECTION 3
 PROPOSED GENERAL ARRANGEMENT
 SHEET 1 OF 4
SHEET NUMBER
 WN02-05-ACM-S3-00-DRG-101 P1

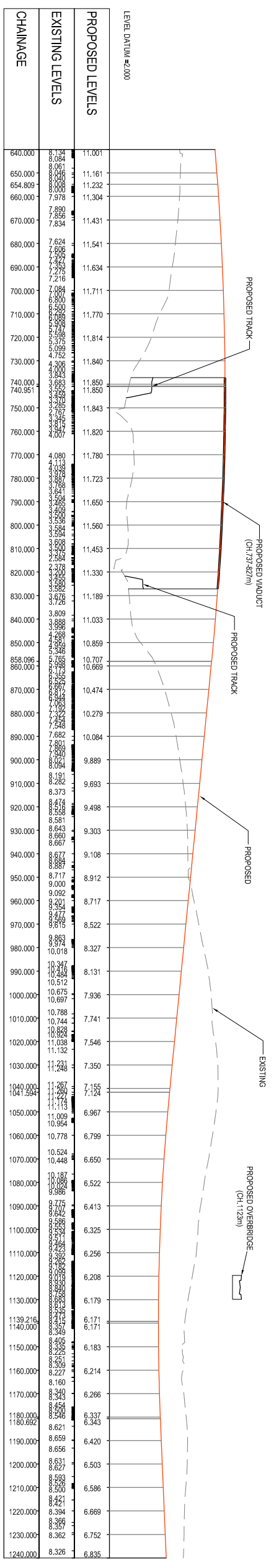
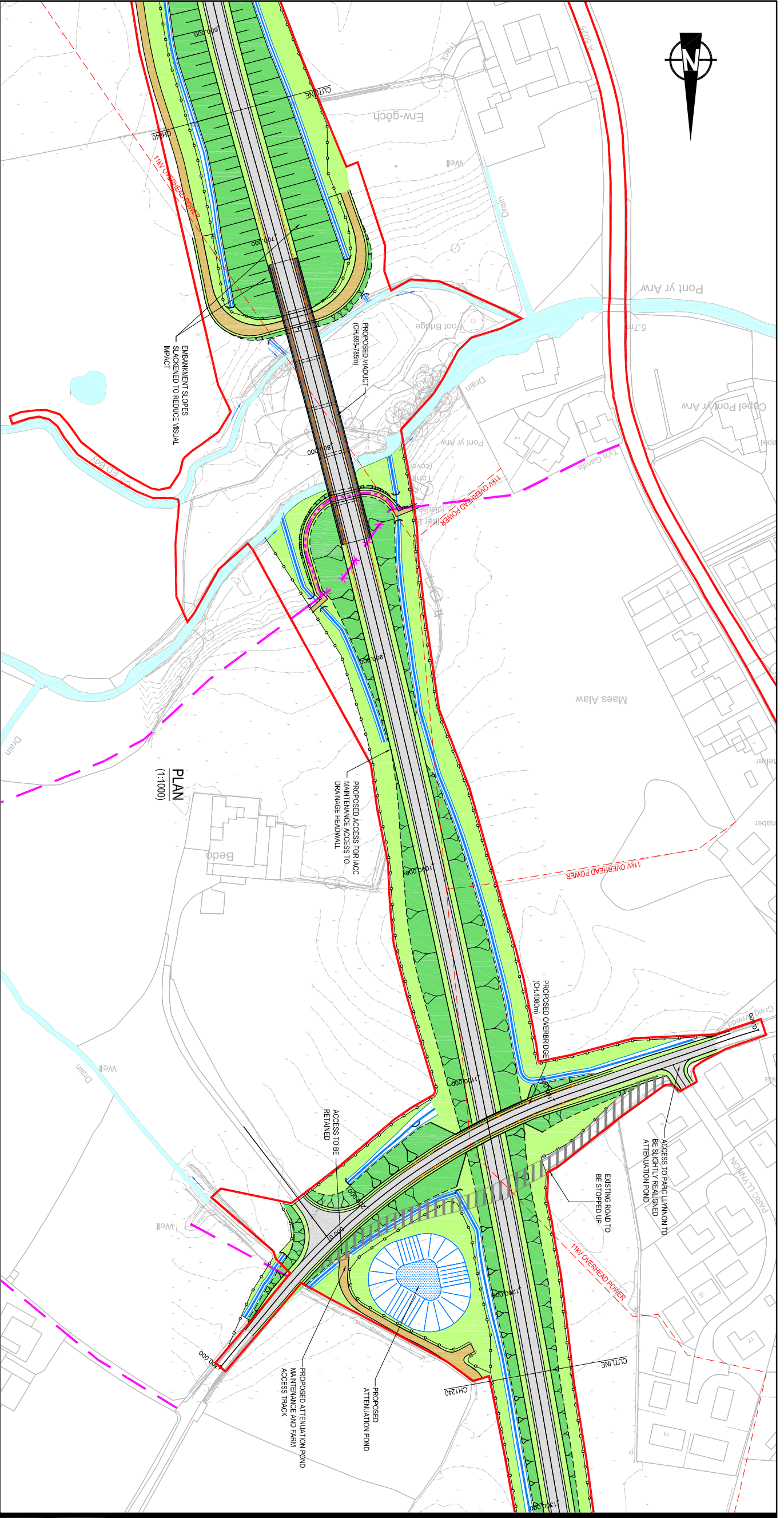

LONGITUDINAL SECTION
 (CHAINAGES: 600m - 1200m)
 (H: 1:1000 V: 1:200)

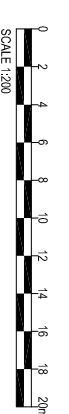
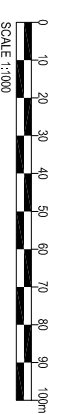

AECOM

PROJECT
 WYLFA
 A5025 HIGHWAY IMPROVEMENTS
 CLIENT

HORIZON NUCLEAR POWER

HORIZON NUCLEAR POWER
 Sunrise House, 1420 Charlton Court,
 Gloucester Business Park, Gloucester,
 GL3 4AE // Tel: 0845 300 6816
 www.horizonnuclearpower.com

CONSULTANT
 AECOM Manchester
 Biddewater House, Whitworth Street,
 Manchester, M1 6LT
 0161 907 3500 tel 0161 907 3599 fax
 www.aecom.com

KEY

- PLANNING APPLICATION RED LINE BOUNDARY
- PROPOSED CARRIAGEWAY
- PROPOSED SHARED USE FOOTWAY/CYCLEWAY
- PROPOSED VERGE
- PROPOSED EARTHWORKS SLOPES
- PROPOSED FARM ACCESS TRACK
- EXISTING WATERCOURSE
- PROPOSED ATTENUATION POND
- PROPOSED HIGHWAY BOUNDARY FENCE
- PROPOSED GATED PUA
- PROPOSED LAND DRAINAGE DITCH
- PROPOSED VEHICLE SAFETY BARRIER

NOTES

- DRAWN AT SCALE 1:1000 @ A1.
- ALL EARTHWORKS BATTER SLOPES ARE SHOWN AT A GRADIENT OF 1 IN 2.5.
- EXISTING GROUND LEVELS BASES ON TOPOGRAFICAL SURVEY INFORMATION FROM RISK SURVEYS UNDERTAKEN IN CONNECTION WITH THIS PROJECT.
- THE ROAD DESIGN IS BASED ON A 7.3m WIDE CARRIAGEWAY PROVIDING A 3.3m TOTAL PAVED WIDTH WITH 1.0m VERGES ON BOTH SIDES OF THE ROAD ALIGNMENT GEOMETRY HAS BEEN DESIGNED IN ACCORDANCE WITH DMRB TD 993.
- ROUNDABOUT GEOMETRY DESIGNED IN ACCORDANCE WITH DMRB TD 1607.
- FOR DETAILS OF PROPOSED DRAINAGE REFER TO DRAWINGS WN02-05-ACM-S5-DRG-001 & 002.

ISSUE/REVISION

NO.	DATE	DESCRIPTION
1	18.11.16	ISSUED FOR COMMENT

PROJECT NUMBER
 47071078

SHEET TITLE
 SECTION 3
 PROPOSED GENERAL ARRANGEMENT
 SHEET 2 OF 4
SHEET NUMBER
 WN02-05-ACM-S3-00-DRG-102 P1

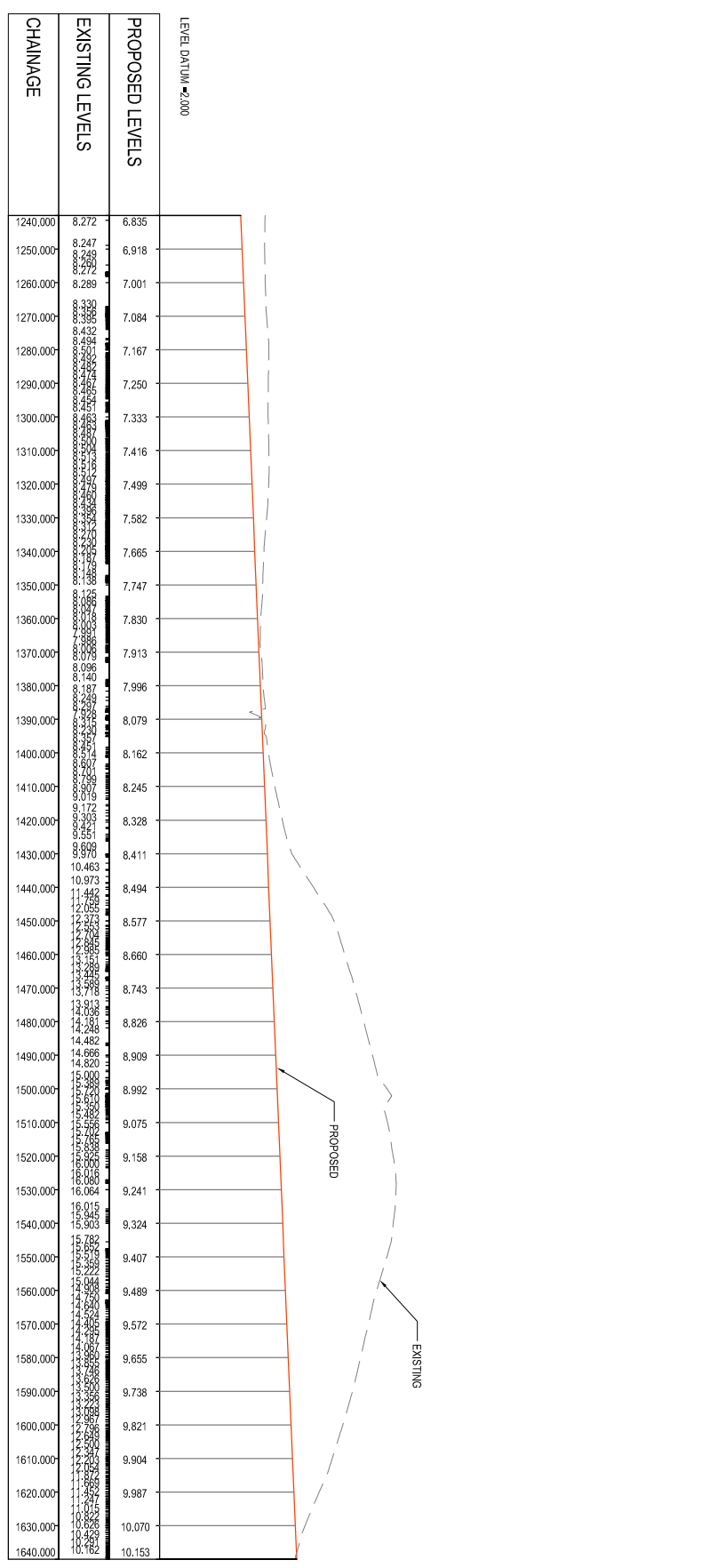
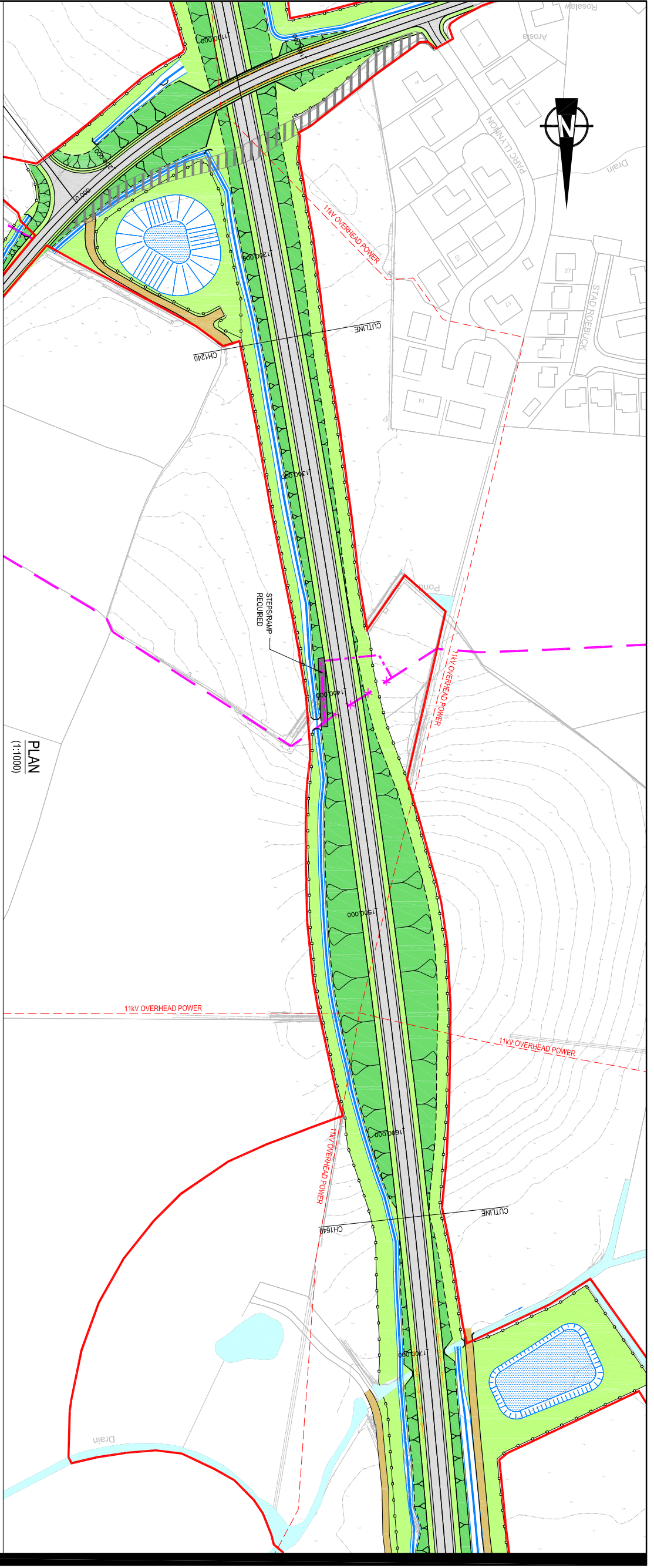

LONGITUDINAL SECTION
 (CHAINAGES: 1200m - 1800m)
 (H: 1:1000 V: 1:200)

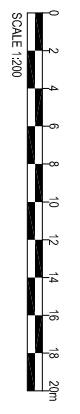
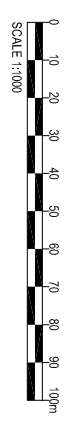

PROJECT
 WYLFA
 A5025 HIGHWAY IMPROVEMENTS
CLIENT



HORIZON NUCLEAR POWER
 Sunrise House, 1420 Chanton Court,
 Gloucester Business Park, Gloucester,
 GL3 4AE // Tel: 0845 300 6816
 www.horizonnuclearpower.com

CONSULTANT
 AECOM Manchester
 Bidevaier House, Whitworth Street,
 Manchester, M1 6LT
 0161 907 3500 tel 0161 907 3599 fax
 www.aecom.com

KEY

- PLANNING APPLICATION RED LINE BOUNDARY
- PROPOSED CARRIAGEWAY
- PROPOSED SHARED USE FOOTWAY/CYCLEWAY
- PROPOSED VERGE
- PROPOSED EARTHWORKS SLOPES
- PROPOSED FARM ACCESS TRACK
- EXISTING WATERCOURSE
- PROPOSED ATTENUATION POND
- PROPOSED HIGHWAY BOUNDARY FENCE
- PROPOSED GATED PUA
- PROPOSED LAND DRAINAGE DITCH
- PROPOSED VEHICLE SAFETY BARRIER

NOTES

1. DRAWN AT SCALE 1:1000 @ A1.
2. ALL EARTHWORKS BATTER SLOPES ARE SHOWN AT A GRADIENT OF 1 IN 2.5.
3. EXISTING GROUND LEVELS BASES ON TOPOGRAFICAL SURVEY INFORMATION FROM RISK SURVEYS UNDERTAKEN IN CONNECTION WITH THE 7.3m WIDE WITH 1.0m HARDSHIPES ON BOTH SIDES OF THE CARRIAGEWAY PROVIDING A 9.3m TOTAL PAVED WIDTH ACCORDANCE WITH DIMB TD 993.
4. ROUNDABOUT GEOMETRY DESIGNED IN ACCORDANCE WITH DIMB TD 1607.
5. FOR DETAILS OF PROPOSED DRAINAGE REFER TO DRAWINGS WNO2.05-ACM-S5-05-DRG-001 & 002.

ISSUE/REVISION

IR	DATE	ISSUED FOR COMMENT
P1	18.11.16	

PROJECT NUMBER
 47071078

SHEET TITLE

SECTION 3
 PROPOSED GENERAL ARRANGEMENT
 SHEET 3 OF 4
SHEET NUMBER
 WNO2.05-ACM-S3-05-DRG-103 P1

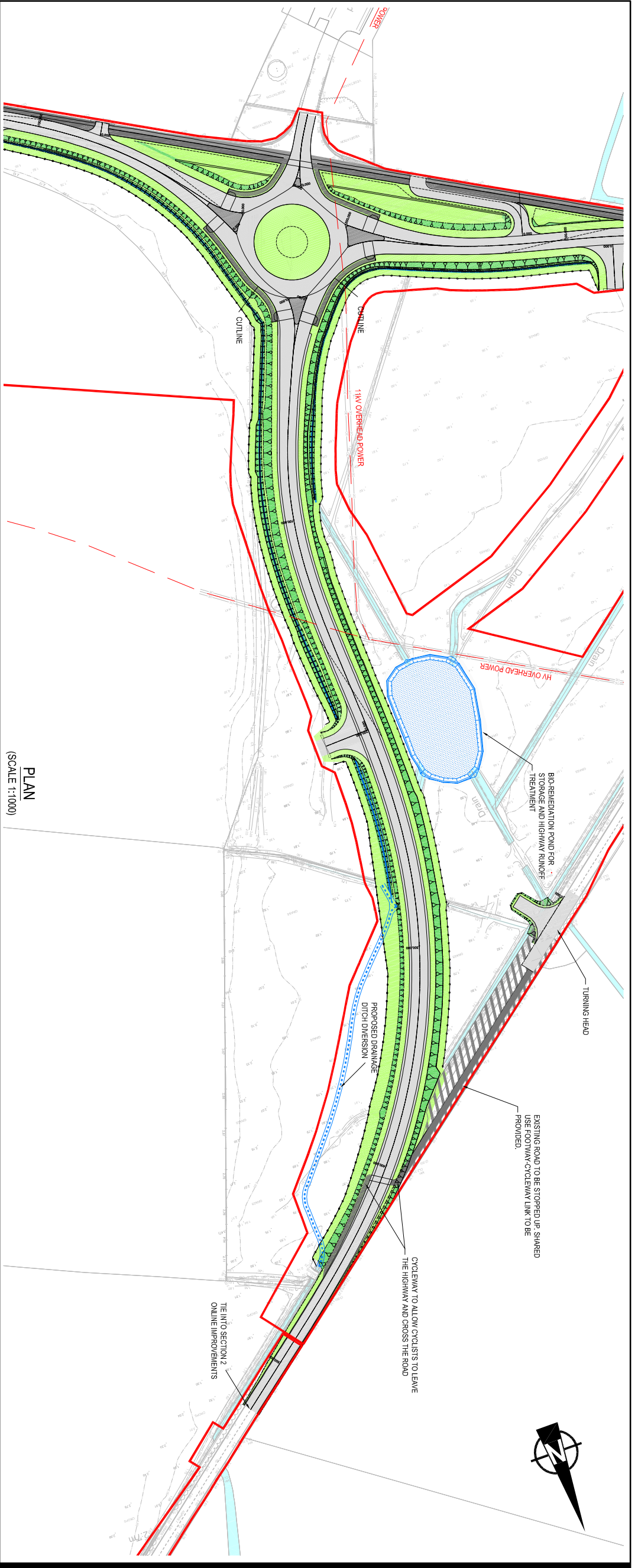

PLAN
(SCALE 1:1000)

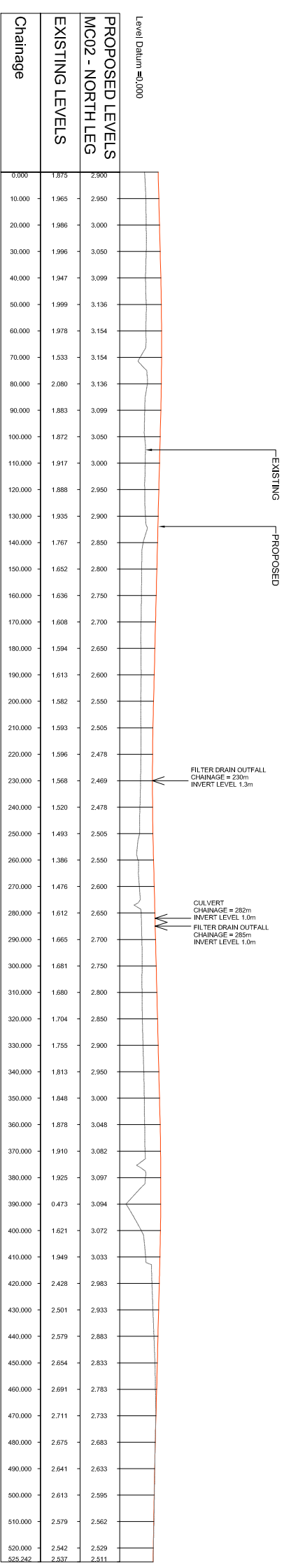

LONGITUDINAL SECTIONS
(SCALE 1:1000H & 1:200V)

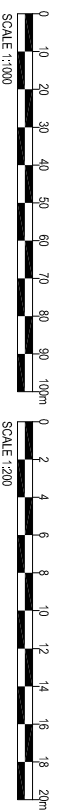

AECOM

PROJECT
WYLFA
AS02S HIGHWAY IMPROVEMENTS
CLIENT

HORIZON
NUCLEAR POWER

HORIZON NUCLEAR POWER
Sunrise House, 1420 Charlton Court,
Gloucester Business Park, Gloucester,
GL3 4AE // Tel: 0845 300 6816
www.horizonnuclearpower.com

CONSULTANT

AECOM Manchester
Bridgewater House, Whitworth Street,
Manchester, M1 6LT
0161 907 3500 tel 0161 907 3599 fax
www.aecom.com

KEY

- PLANNING APPLICATION RED LINE BOUNDARY
- PROPOSED CARRIAGEWAY
- PROPOSED SEGREGATED FOOTWAY-CYCLEWAY
- PROPOSED SHARED USE FOOTWAY-CYCLEWAY
- PROPOSED VERGE
- PROPOSED EARTHWORKS SLOPES
- EXISTING WATERCOURSE
- PROPOSED ATTENUATION POND
- PROPOSED HIGHWAY BOUNDARY FENCE
- PROPOSED GATED PIA
- PROPOSED LAND DRAINAGE DITCH
- PROPOSED DRAINAGE DITCH DIVERSION

NOTES

1. DRAWN AT SCALE 1:1000 @ A1.
2. ALL EARTHWORKS BATTER SLOPES ARE SHOWN AT A 1:1 BATTER.
3. EXISTING GROUNDLEVELS BASES ON TOPOGRAPHICAL SURVEY INFORMATION FROM RSK SURVEYS UNDERTAKEN IN DECEMBER 2014.
4. THE PROPOSED CARRIAGEWAY WIDTH IS 7.2m WIDE WITH 1.0m HARDSTRIPS ON BOTH SIDES OF THE CARRIAGEWAY PROVIDING A 9.3m TOTAL PAVED WIDTH. ROAD ALIGNMENT GEOMETRY HAS BEEN DESIGNED IN ACCORDANCE WITH DMRB TD 983.
5. ROUNDABOUT GEOMETRY DESIGNED IN ACCORDANCE WITH DMRB TD 1607.
6. FOR DETAILS OF PROPOSED DRAINAGE REFER TO DRAWINGS WN02.05-ACM-S1-05-DRG-001 & 002.

ISSUE/REVISION

PI	DATE	ISSUED FOR COMMENT
PI	04.11.16	ISSUED FOR COMMENT
JLR		DESCRIPTION

PROJECT NUMBER

47071078

SHEET TITLE

SECTION 1
PROPOSED GENERAL ARRANGEMENT
SHEET 2 OF 2

SHEET NUMBER

WN02.05-ACM-S1-00-DRG-102 P1